



# STHAPATI ENTERPRISES PVT. LTD.

CONSULTING ENGINEERS. ARCHITECTS. CIVIL CONTRACTORS. DEVELOPERS. PROMOTERS

## DECLARATION

Premises No.: **34D, Charu Chandra Avenue, P.S. Tollygunge, Ward 81, Kolkata 700 033**

Assessee No.: **11 - 081 - 02 - 0068 - 6, K.M.C.**

Name of the Owner(s): **Mohan Kishore Chatterjee**

Name of the Applicant(s): **Mr. Soumya Kanti Dasgupta**, The Designated Director as well as Authorized Signatory / Representative of STHAPATI ENTERPRISES PRIVATE LIMITED, Lawful Constituent Attorney of Mr. Mohan Kishore Chatterjee

Area of the Land: **187.291 SQM** i.e., 2K - 12 Ch. - 36 SFT (more or less)

Permissible Height in Reference to CCZM Issued by AAI: **101.58 Meter**

Proposed Height of the Building: **15.475 Meter + 4.80 Meter** (Above Roof Structure)

Co-ordinates in WGS-84 Datum and Site Elevation (in Meter AMSL):

Reference points marked in the Site plan of the proposal	Co - Ordinate in WGS - 84 Datum		Site Elevation (in Meter AMSL)
	Latitude	Longitude	
A	22° 30' 25.4" N	88° 20' 33.5" E	10.8

The above information is true and correct in all respect and if any stage, it's found otherwise, I shall be fully liable and other appropriate authority reserves the right to take appropriate action against me / us as per law.

The site does not fall within Red Zone of CCZM (AAI) [ i.e., Yellow Zone / Grid U16)

Sthapati Enterprises Private Limited

Managing Director

Signature of the Applicant(s)

Date:

Place: Kolkata

GROUND + FOUR STORIED [ TOTAL HEIGHT 15.475 METER ] RESIDENTIAL BUILDING AT PREMISES NO. 34 D, CHARU CHANDRA AVENUE, WARD NO. 081, P. S. CHARU MARKET, KOLKATA 700 033 UNDER BOROUGH X [ K. M. C. ]

AREA OF THE LAND: 187.291 SQM i.e., 2K - 12 CH. - 36 SFT (MORE OR LESS)

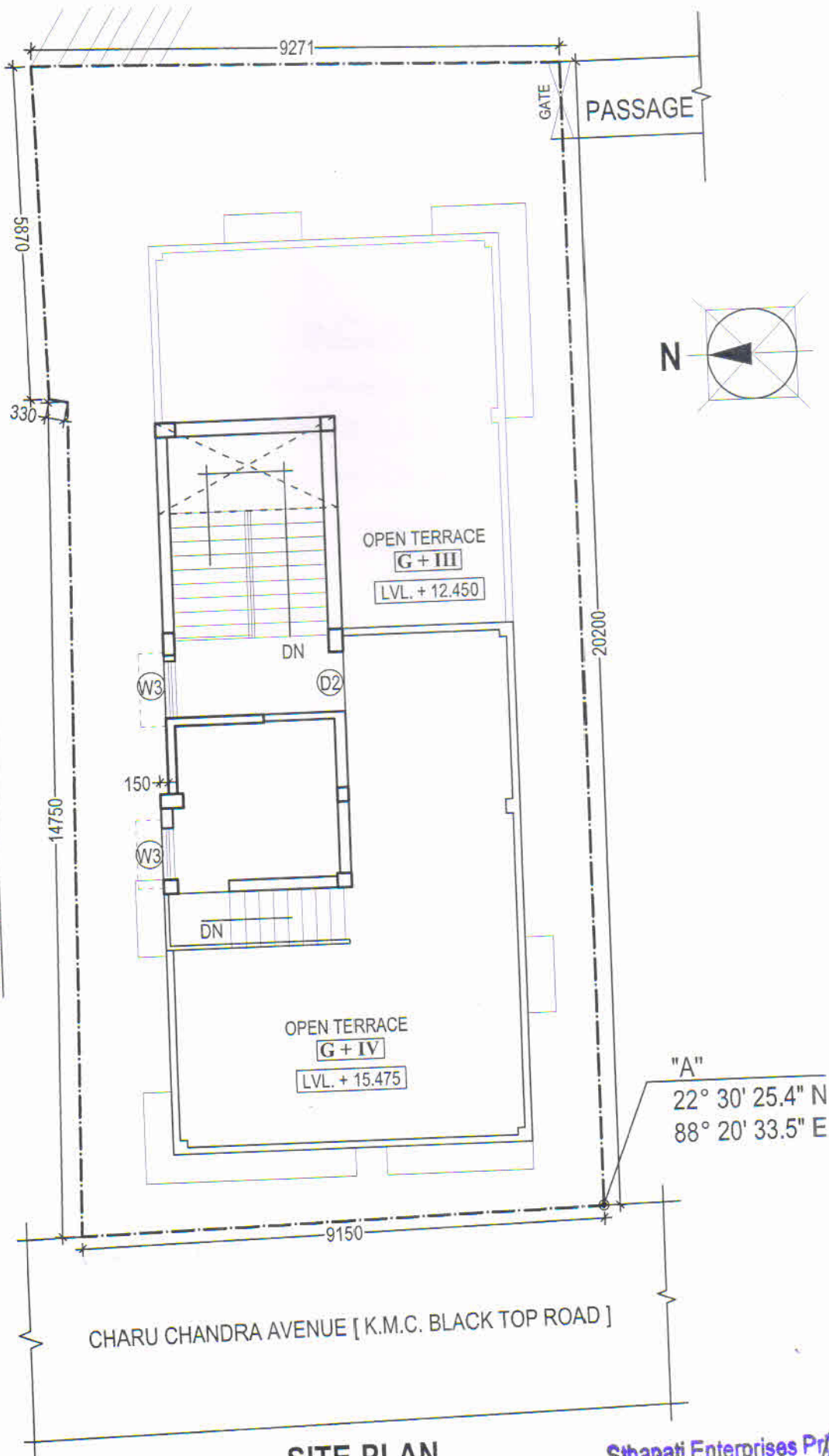

**SITE PLAN**  
( SCALE: 1: 100 )

**Sthapati Enterprises Private Limited**  
Managing Director